



Give life to your project

Q and Qx System

Q and Qx System



Description

The Q and Qx system is a kind of metal ceiling which offers an additional degree of flexibility in comparison to the M system.

In this system, in addition to principal bartacks, there are intermediate bartacks that allow the development of a metal ceiling characterized by an orthogonal mesh under which it will be easy to manage highly reconfigurable environments. In fact, each bartack draws a natural invitation to insert walls.

Main features

Panel module

-Mod. Sistema Q: 1000x1000 mm
-Mod. Sistema Qx: custom

Material and Colour

-Coil coated Steel:
RAL 9010, 9003, 9006
-Powder coated Steel:
RAL 9010, 9003, 9006
-Coil coated Aluminum:
RAL 9003,9006
(other RAL colours available
on request)

Sound absorption

TNT black

Q and QX System elements

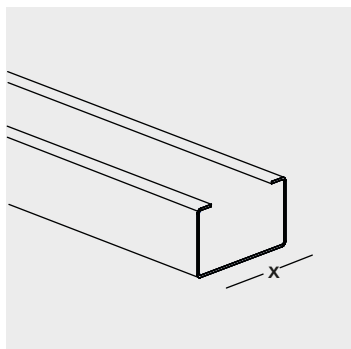

BARTACK

50, 100, 150, 200, 250, 300

M SP* = min 50 mm max 300 mm

*SP: special with out of module width

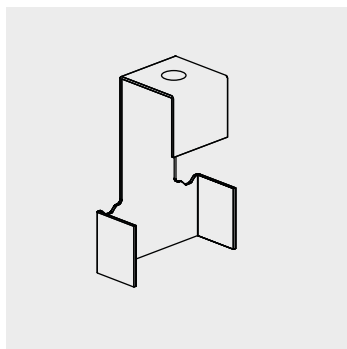

BRACKET

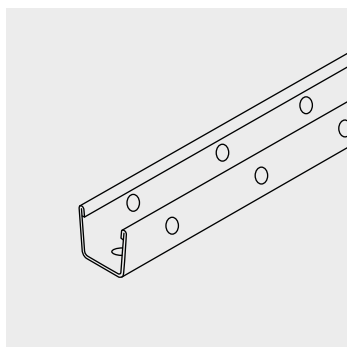

"U" PROFILE

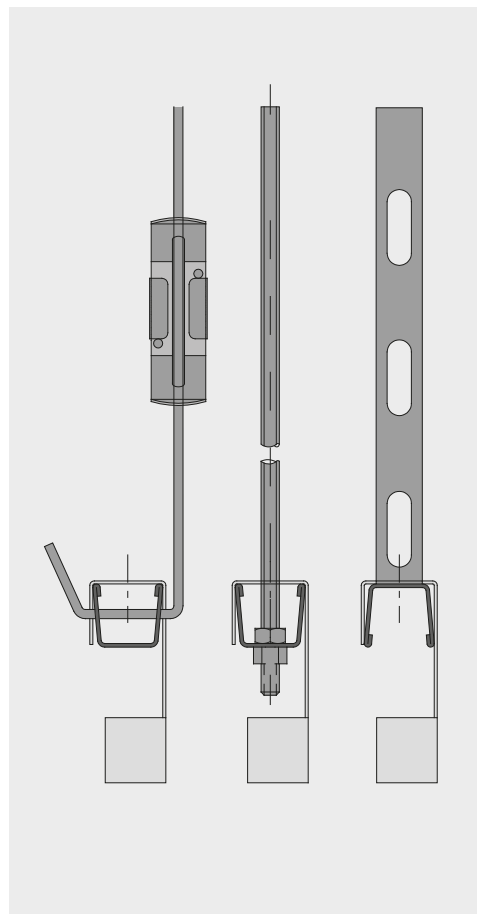

SUSPENDING

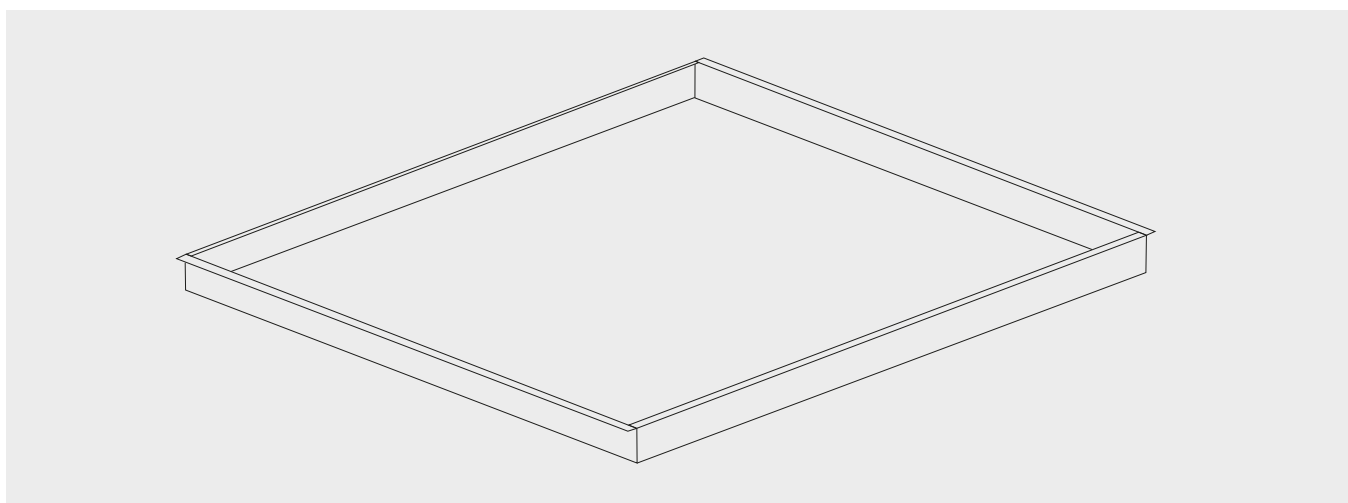

PANEL

Panel Q

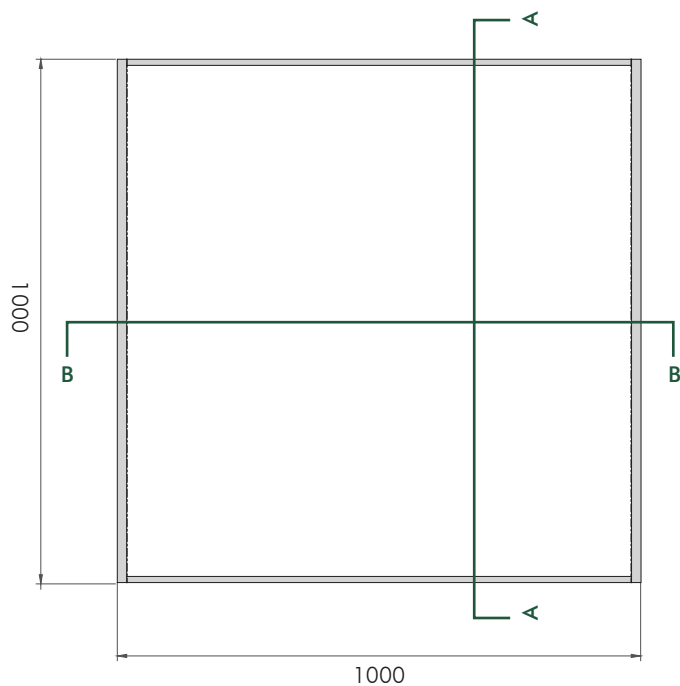

Panel Qx

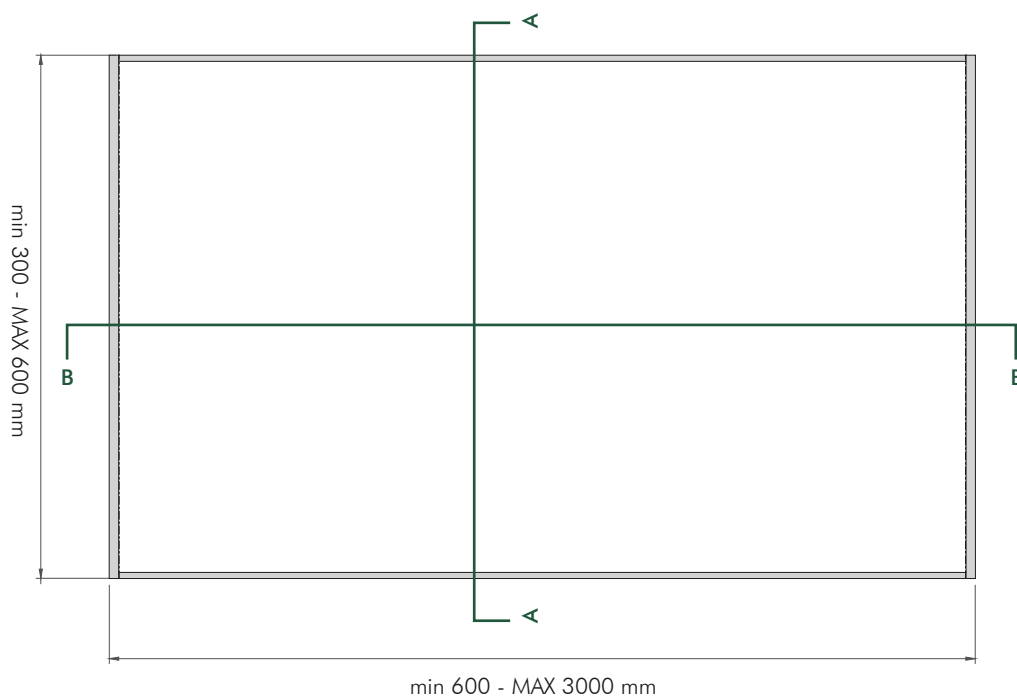

Section A - A' _ Standard edges

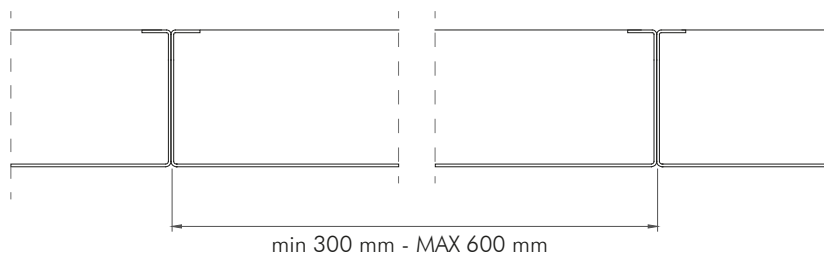

Section B - B' _ Standard edges

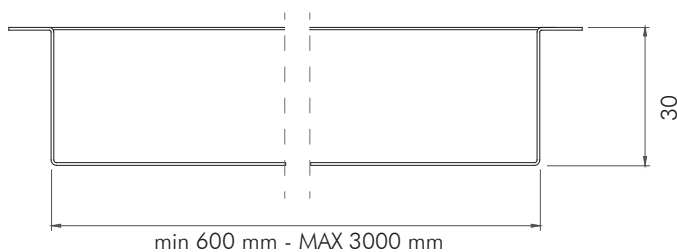

Section A - A' _ Tilting edges

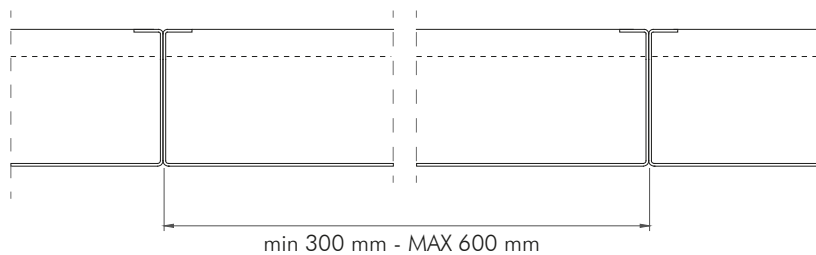

Section B - B' _ Tilting edges

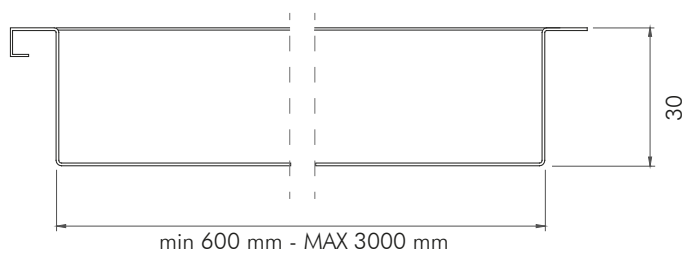

Structure

Section C-C

The structure consists of an orthogonal mesh, created through the use of U profiles and Bartack of various sizes, positioned according to the dimensions of the panel.

The two elements are suitably joined together by using a bracket sized on the basis of the bartack. Slots, in the U profile, are perforated with a 50 mm distance and allow the installer to choose the type of hangers among those identified (recommended at a maximum distance of 1200 mm), thus making installation simple and practical.

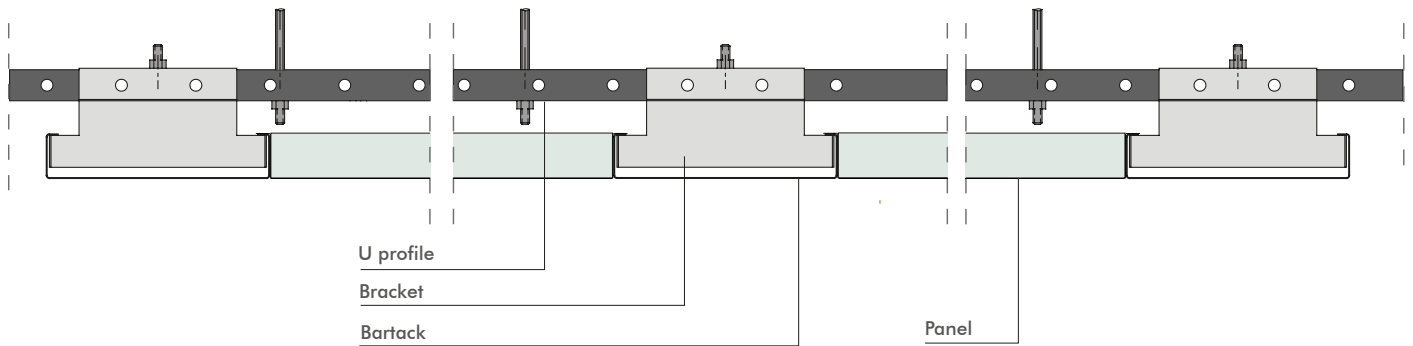
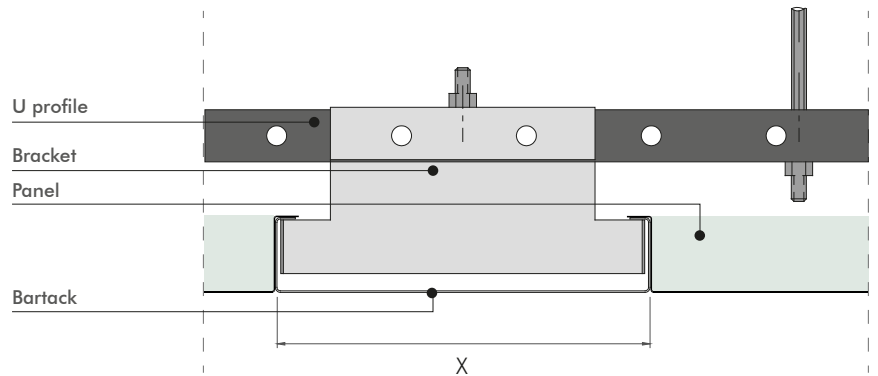

Bracket

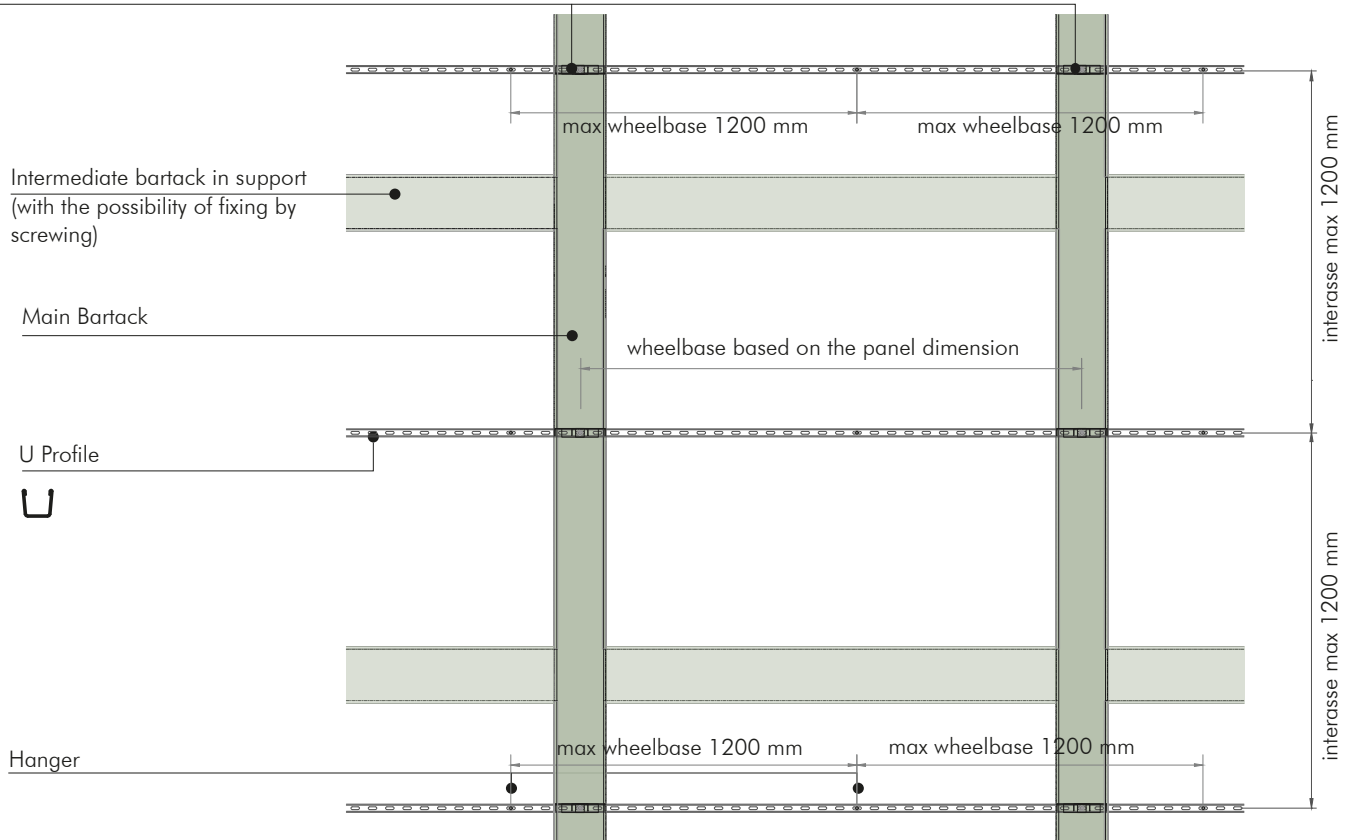

* wheelbase indicated are to be checked according to the load per m²

Bartack Composition

First Bartack

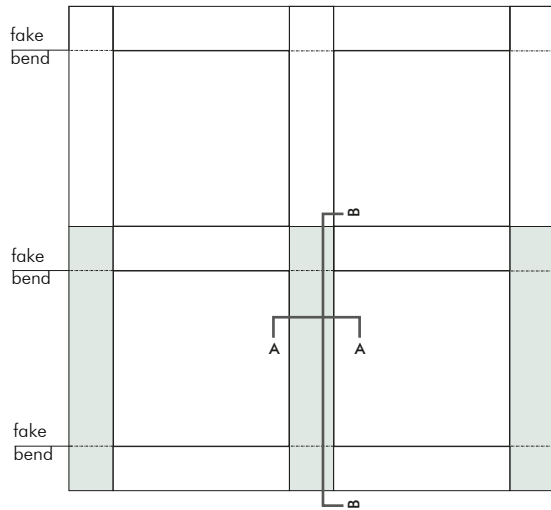

Section A - A

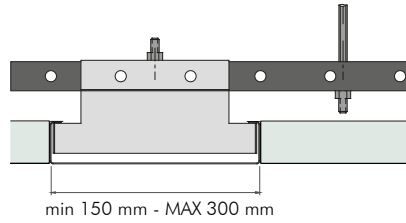

Section B - B

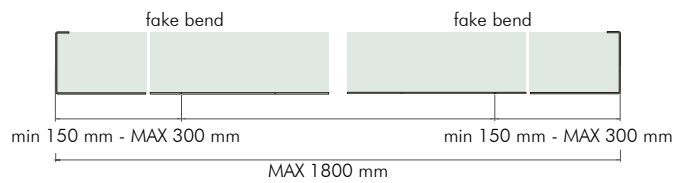

Bartack

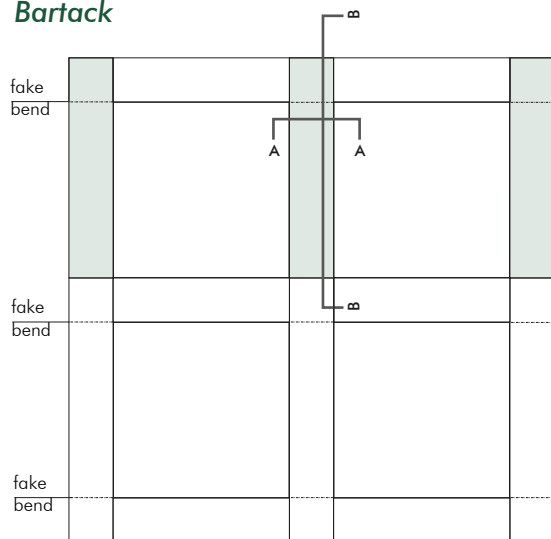

Section A - A

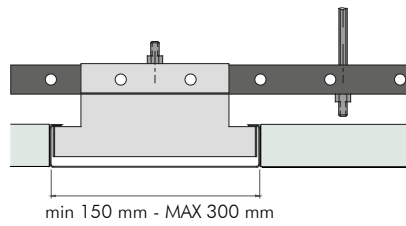

Section B - B

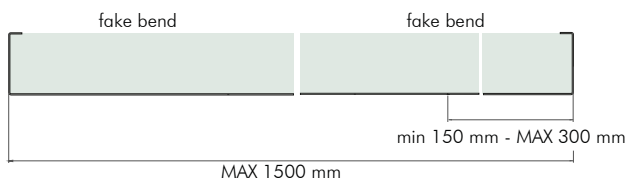

Middle Bartack

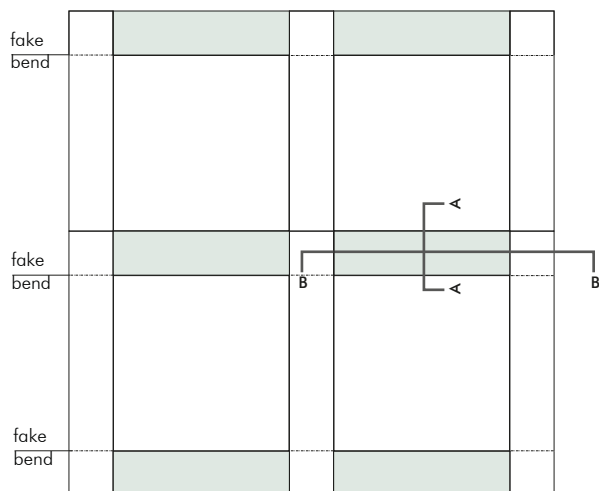

Section A - A

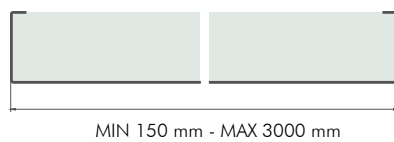

Section B - B

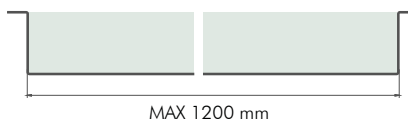

Perimetral's details

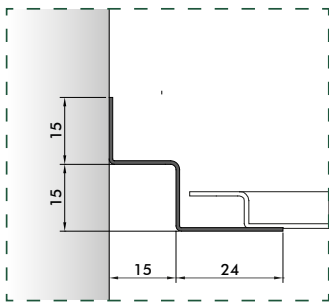

P11_L 3000 mm

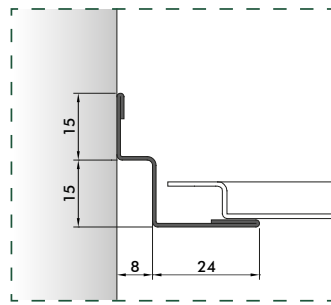

P11/A_L 3050 mm

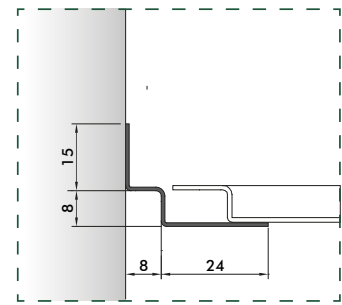

P12_L 3000 mm

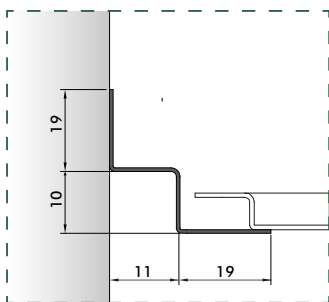

P15/A_L 3000 mm

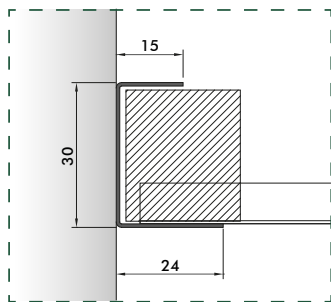

P10 *_L 3000 mm

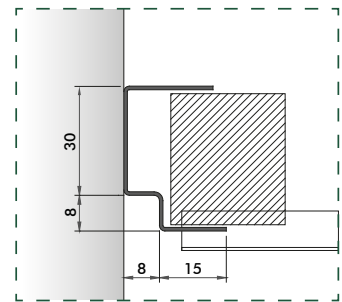

P13 *_L 3000 mm

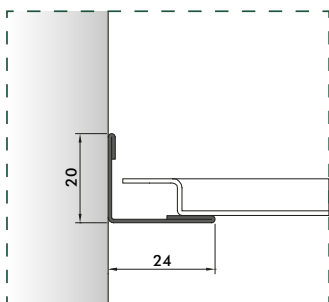

P2_L 3000 mm

Each profile can be achieved with customized section in according to customer's requests.

* Supplied on request with polystyrene to maintain in the form the cut panel (supplied not pre-assembled)

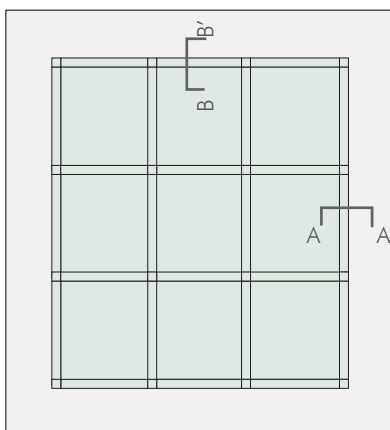

Perimeter finish made with the same load-bearing bartack.

For this solution it will be necessary to create a perfectly square compensation veil

Section B - B

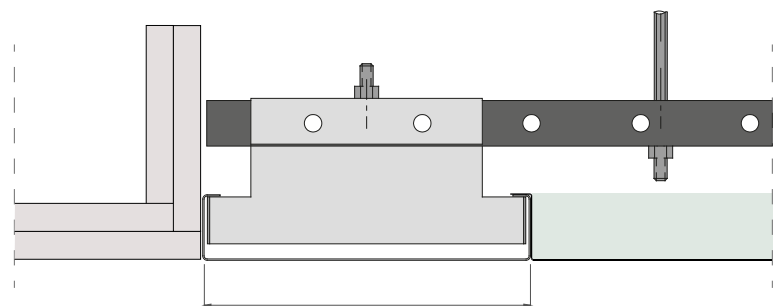

Section A - A

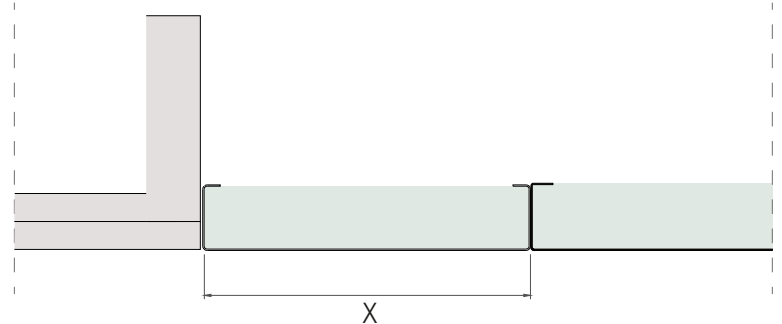

Performance and technical data



Perforation
type



α_w *



Classe**



Recycled
content (%)***



Reaction to
fire class****



%RH

Perforation type	α_w *	Classe**	Recycled content (%)***	Reaction to fire class****	%RH
Panel not perforated	0,10	NC	<30	A1	95
R0701	0,55	D	<30	A1	95
R1511	0,70	C	<30	A1	95
R211	0,70	C	<30	A1	95
R2516	0,75	C	<30	A1	95
D1522	0,75	C	<30	A1	95
D222	0,70	C	<30	A1	95
Acoustic R1511	1,00	A	≤30	A1	95
Acoustic D1522	1,00	A	≤30	A1	95

* including non-woven fabric (black TNT) certified and hot applied.

** according to EN ISO 11654

*** please note that all aluminum and steel products are 100% recyclable.

**** Intended use of the product according to EN13964: 2014 / A1: 2006: Components of suspended ceiling membranes for internal use in buildings. System of assessment and verification of constancy of performance of the construction product: SYSTEM 3.

***** for any other technical information, please contact our sales or technical office.

Perforation Options

Regular

R0701

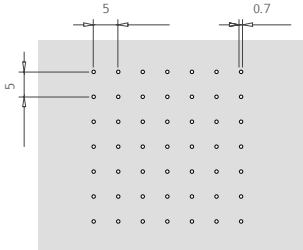

aw 0.55 - EXTRA MICRO PERFORATION
 Diameter : 0.7 mm
 Perforation area : regular central or total
 Inter-axes : 5x5 mm
 Perforation surface : 1.5% approx.

R1511

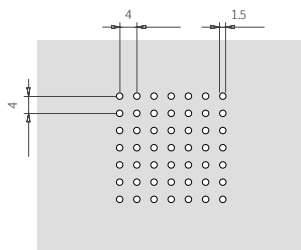

aw 0.70 - MICRO PERFORATION
 Diameter: 1.5 mm
 Perforation area: regular central or total
 Inter-axes: 4x4 mm
 Perforation surface: 11% approx.

R1610

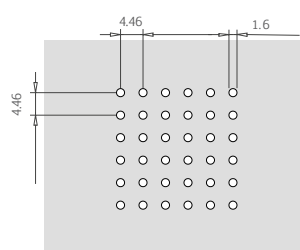

Diameter: 1.6 mm
 Perforation area: regular central or total
 Inter-axes: 4.46x4.46 mm
 Perforation surface: 10% approx.

R211

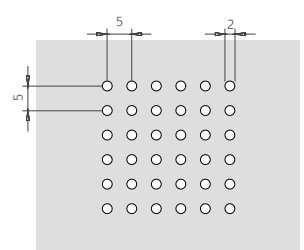

aw 0.70
 Diameter: 2 mm
 Perforation area: regular central or total
 Inter-axes: 5x5 mm
 Perforation surface: 11% approx.

R2516

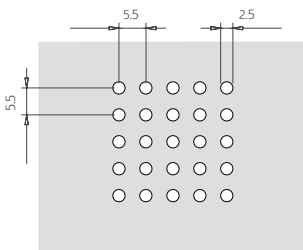

aw 0.75
 Diameter: 2.5 mm
 Perforation area: regular central or total
 Inter-axes: 5.5x5.5 mm
 Perforation surface: 16% approx.

R308

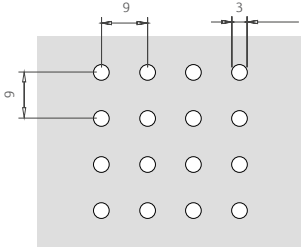

Diameter: 3 mm
 Perforation area: regular central or total
 Inter-axes: 9x9 mm
 Perforation surface: 8% approx.

R4530

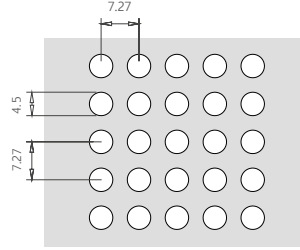

Diameter: 4.5 mm
 Perforation area: regular central or total
 Inter-axes: 7.27x7.27 mm
 Perforation surface: 30% approx.

Diagonal

D1522

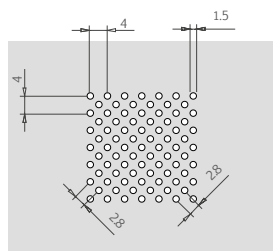

aw 0.75 - MICRO PERFORATION
 Diameter: 1.5 mm
 Perforation area: diagonal central or total
 Inter-axes: 4x4 mm
 Perforation surface: 22% approx.

D220

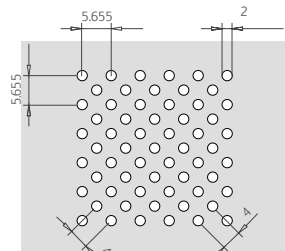

Diameter: 2 mm
 Perforation area: diagonal central or total
 Inter-axes: 5.655x5.655 mm
 Perforation surface: 20% approx.

D222

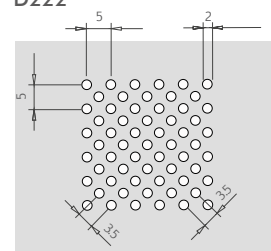

aw 0.70
 Diameter : 2 mm
 Perforation area: diagonal central or total
 Inter-axes: 5x5 mm
 Perforation surface : 22% approx.

D316

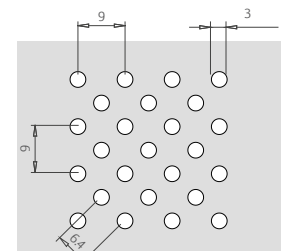

Diameter: 3 mm
 Perforation area: diagonal central or total
 Inter-axes: 9x9 mm
 Perforation surface: 16% approx.

D1620

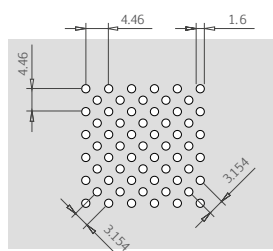

Diameter: 1.6 mm
 Perforation area: diagonal central or total
 Inter-axes: 4.46x4.46 mm
 Perforation surface: 20% approx.

Perforation Options

Square

Q540

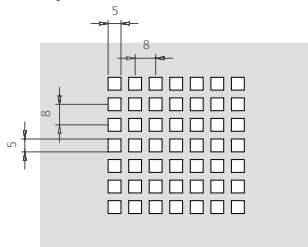

Hole: 5x5 mm
 Perforation area: regular central or total
 Inter-axes: 8x8 mm
 Perforation surface: 40% approx.

Q1045

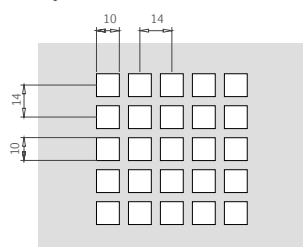

Hole: 10x10 mm
 Perforation area: regular central or total
 Inter-axes: 14x14 mm
 Perforation surface: 45% approx.

Q1020

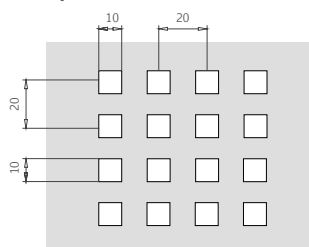

Hole: 10x10 mm
 Perforation area: regular central or total
 Inter-axes: 20x20 mm
 Perforation surface: 20% approx.

Q509

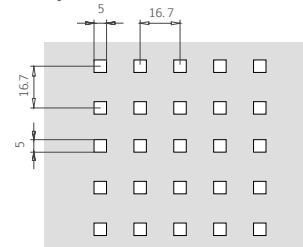

Hole: 5x5 mm
 Perforation area: regular central or total
 Inter-axes: 16.7x16.7 mm
 Perforation surface: 9% approx..

Hexagonal

E2530

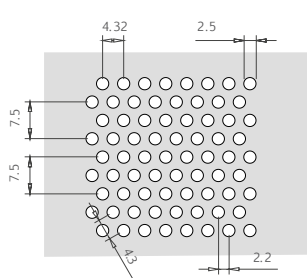

Diameter: 2.5 mm
 Perforation area: diagonal central or total
 Inter-axes: 4.3x7.5 mm
 Perforation surface: 30% approx.

E332

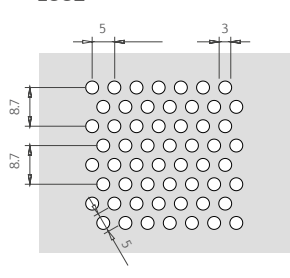

Diameter: 3 mm
 Perforation area: diagonal central or total
 Inter-axes: 5x8.7 mm
 Perforation surface: 32% approx.

04/5,5x5,5

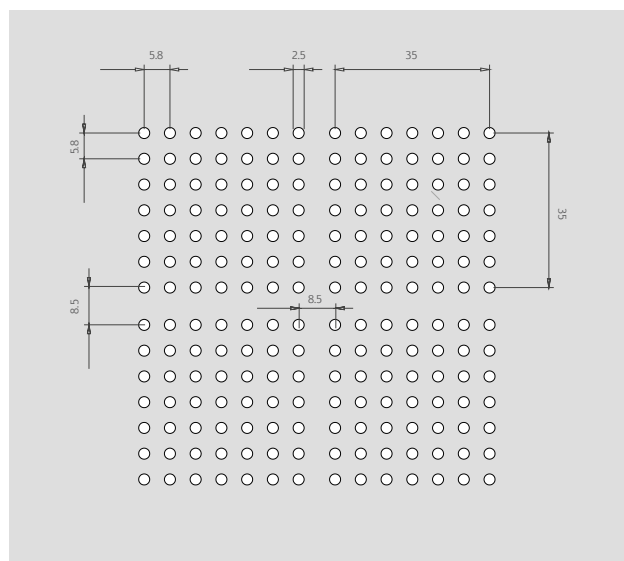

Diameter: 2.5 mm
 Perforation area: regular 35x35 mm
 Inter-axes: 8.5 mm
 Perforation surface: 15% approx.

General informations

Technical Standards

All Profilsystem products are CE marked according to EN 13964. They are also accompanied by the Declaration of Performance (D.O.P.) as required by European regulation 305/11 concerning the placing of construction products on the market.

For applications in particularly aggressive environments such as swimming pools, industrial installations with chemical and / or corrosive fumes, check the most suitable material and surface treatment with the technical or commercial office of Profilsystem.

Storage

All products are carefully packed and placed on special pallets and secured by strapping and film wrapping. On request we can provide the package complete of cardboard corners, bubble wrap and polystyrene to reduce the risks during transport.

It is always recommended to handle all packaging with the most care, avoiding shocks and practices that damage the contents. The packed material is stored in closed, clean and dry places until the time of pic-up.

Do not expose filmed products to heat sources and do not leave them under the sun.

Installation

The metal ceiling are installed manually by the installer depending on the type and model you choose.

The material should be stored in closed, clean and dry places until the time of installation.

Do not rest on the ground and not leave the products on site without the original package issued at the time of delivery.

Avoid the contact between material and water, solvents, degreasers and aggressive liquids.

Cleaning and Maintenance

Metal ceilings, thank to the easy washing and cleaning are also a guarantee in terms of hygiene.

To remove dust, stains or smudges you can use carefully a clean, dry cloth or moistened with neutral detergent, or non-abrasive and non-aggressive disinfectants.



Give life to your project

ITALY

Head quarter & showroom

Via Don Luigi Sturzo,3 - 20822 Seveso (MB) Italy
tel: +39 0362 625652 - fax: +39 0362 306733
www.profilsystem.com

DUBAI

Sales offices & showroom

TOP 27 CONSULTING JLT
Office 3205 - JBC2
Cluster V - JLT
Dubai - United Arab Emirates
middleeast@profilsystem.com

CHILE

Sales offices & showroom

COMERCIAL E.V.A. Limitada
Avenida La Dehesa 1844
Ufficio 714
Lo Barnechea, Santiago de Chile
tel: +59 9 51599037
info@nenzi.cl

SPAIN

Sales offices & showroom

PROFILSYSTEM EPC
Techos de Aluminio
C/ Lluís Companys, 52
08810 Sant Pere de Ribes, Barcelona
tel: +34 666 431 921
info@profilsystem.es

Our offices are at your disposal

SALES OFFICE ITALY:

Elis Zappino
elis@profilsystem.com
Skype ID [elis.zappino](#)

Dott. Riccardo Ghezzi
riccardo@profilsystem.com
Skype ID [ghezziriccardo](#)

EXPORT OFFICE:

Dott. Alexa Maj
export@profilsystem.com
Skype ID [Alexa Maj](#)

TECHNICAL OFFICE:

Arch. Manuela De Cristofaro
tecnico@profilsystem.com
Skype ID [Manuela De Cristofaro](#)

SHIPPING OFFICE:

Chiara Talon
chiara.talon@profilsystem.com
Skype ID [talon.chiara](#)